



Warning: Spoiler Alert

On the next page of this document you will find a refill guide for EXIT® Advent Calendar — The Silent Storm.

You do NOT need this refill guide to play the game.

It will also NOT help you solve the puzzles. You ONLY need it, if, during the game you get the impression that puzzle cards or strange items are missing or have slipped into the wrong room. At that point you can use this refill guide to check.

Warning: Have the calendar checked **by someone who is not involved in the game** to avoid spoilers!

DO NOT read the next page if you want to play the game yourself!



ADVENT CALENDAR

The Silent Storm — Refill Guide

IMPORTANT! Make sure that the vertical bars with the correct colour markings are in the right place!

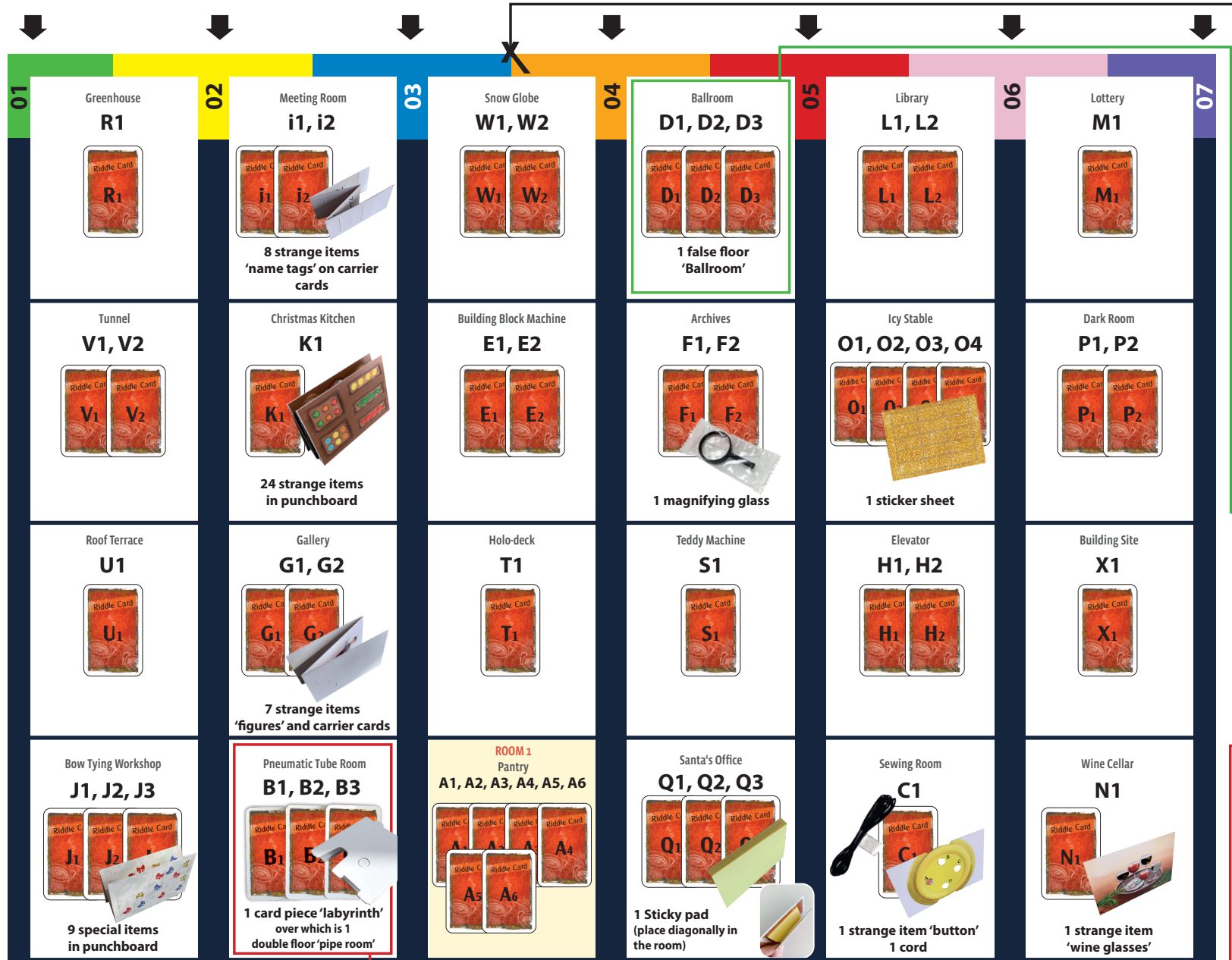

Would you like to check the contents of the EXIT® Advent Calendar and sort them out if necessary?

Open one of the side flaps and pull the tray out carefully. Put the open tray in front of you as shown.

Sort the contents as shown, then carefully slide the tray back into the case and close the calendar

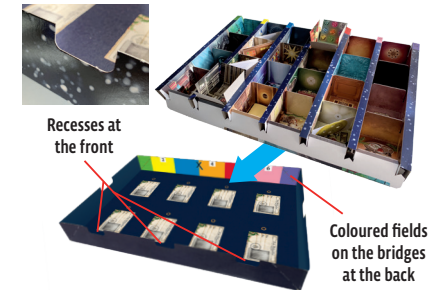

a) Firstly place the cardboard piece 'Labyrinth' with the large opening facing forward. You should NOT be able to see the yellow face.

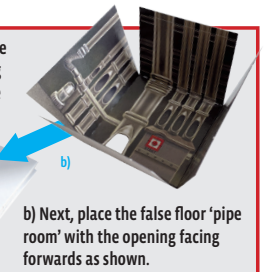

b) Next, place the false floor 'pipe room' with the opening facing forwards as shown.



Note: When replacing the tray back into the box, the "Nothing to see here!" text should be on the right hand side.